

ADDENDUM NUMBER THREE

March 4, 2019

To all bidders of record for the work titled:

Madison School District #321 Middle School HVAC Remodel

Project Number: 746

Please notify everyone concerned, including suppliers as to the issuance and contents of this Addendum prior to the date of bid opening. This Addendum is a part of the contract documents and modifies them as follows:

This Addendum consists of 2 pages(s) including attached drawing(s).

I. GENERAL

N/A

II. SPECIFICATIONS

N/A

III. DRAWINGS

A. Replace Sheet A1.3 – Main Level Ref. Ceiling Plan, with attached

End of Addendum #3

CEILING MATERIAL LEGEND	
	12' x 12' ACOUSTICAL GLUE ON CEILING AND LIGHTS OVER PATCHED, REPAIRED, AND PREPARED SURFACE AS REQUIRED TO RECEIVE NEW WORK.
	NEW 24' x 24' ACOUSTICAL CEILING AND GRID SYSTEM.
	EXISTING ACOUSTICAL CEILING AND GRID SYSTEM TO REMAIN, PROTECT.
	EXISTING LIGHT FIXTURES.
	NEW LIGHT FIXTURES.

KEY NOTES

- ① EXISTING WORK TO REMAIN, PROTECT. TYP. UNLESS NOTED OTHERWISE.
- ② SEE BID ALTERNATE #1 BID DOCUMENTS FOR WORK IN THIS AREA.
- ③ PATCH AND REPAIR EXISTING GYPSUM AS REQUIRED BY INSTALLATION OF MECHANICAL WORK. MATCH EXISTING GYPSUM BOARD THICKNESS. TAPE AND SKIM COAT ALL GYPSUM TO PROVIDE SMOOTH FINISH FOR NEW GLUE-ON CEILING TILES AND LIGHTS.
- ④ PATCH AND REPAIR EXISTING GYPSUM, SKIM COAT AS REQUIRED TO PROVIDE SMOOTH FINISH FOR NEW GLUE-ON CEILING TILES AND LIGHTS.
- ⑤ NEW SUSPENDED CEILING TILE ASSEMBLY
- ⑥ EXISTING BULKHEAD
- ⑦ REMOVE & REINSTALL EXISTING SUSPENDED CEILING AS REQ'D TO ACCOMMODATE NEW WORK AT EXISTING CEILING MOUNTED HVAC UNIT
- ⑧ INSTALL NEW 30"x 30" CEILING ACCESS DOOR ADJACENT TO EXISTING UNIT HEATER. COORD. W/ MECH. CONTRACTOR FOR LOCATION
- ⑨ UNVENTED 20 GA. METAL SOFFIT SYSTEM ATTACHED TO STRUCTURE.
- ⑩ EXISTING EXTERIOR LIGHT TO BE REMOVED CAP WIRES AND PROVIDE WATER PROOF JUNCTION BOX.

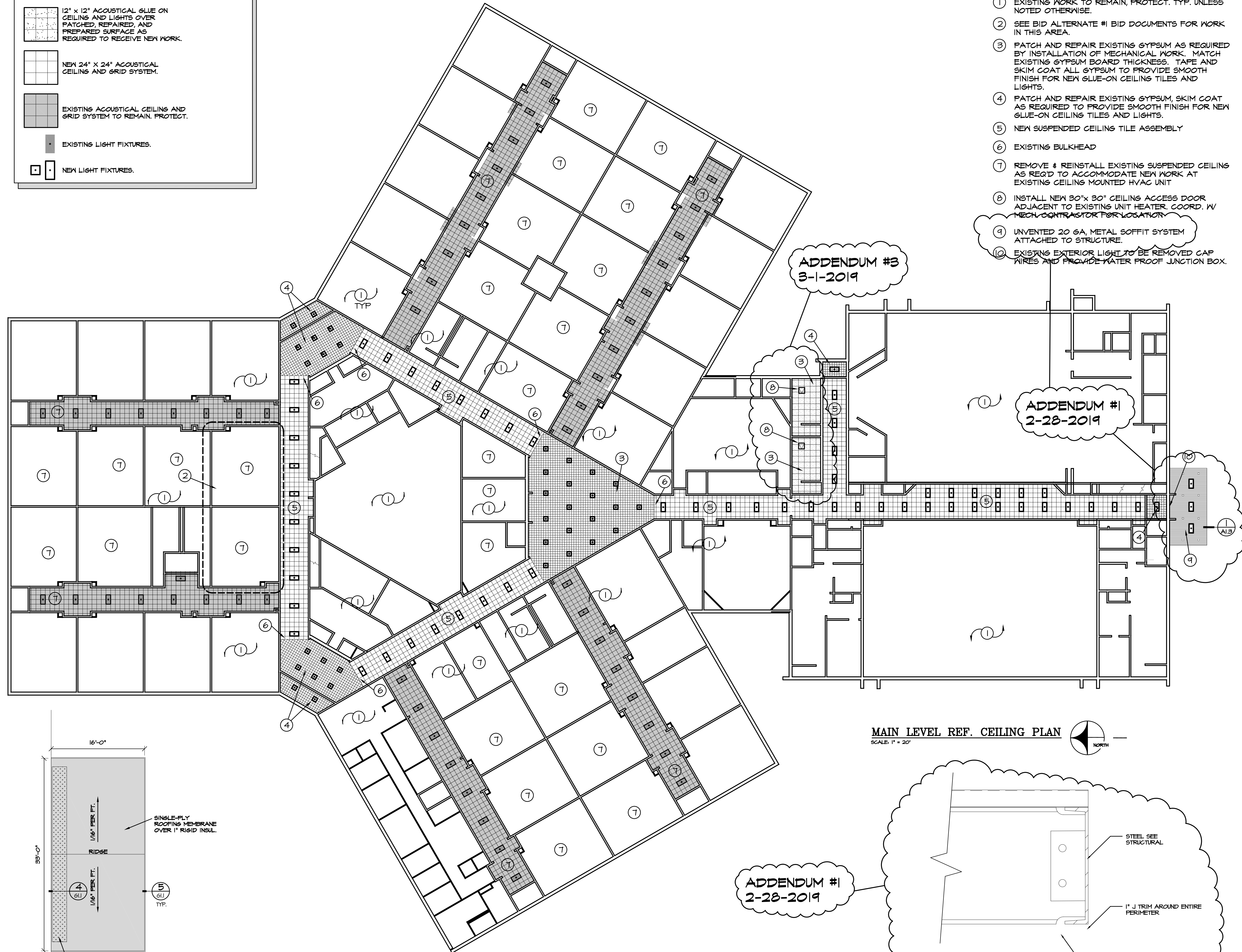

MAIN LEVEL REF. CEILING PLAN
SCALE: 1" = 20'

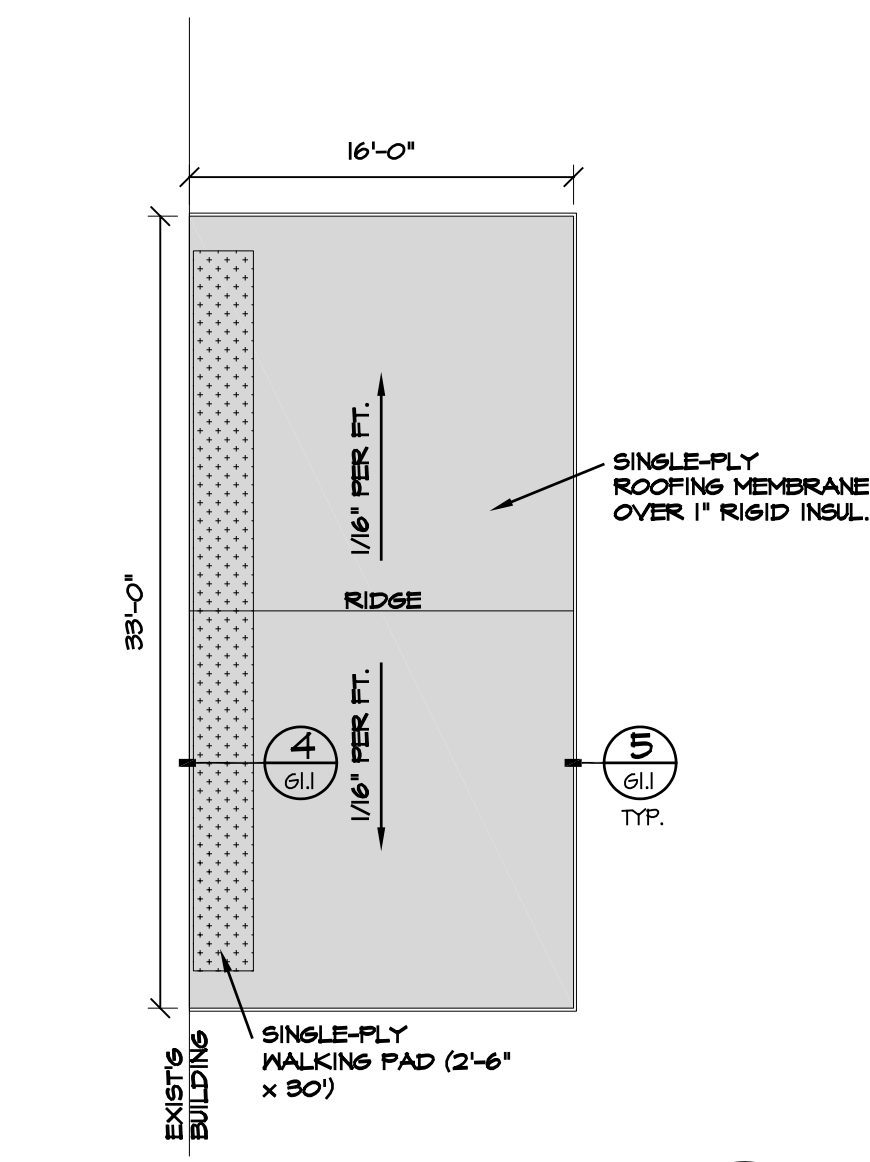

PARTIAL ROOF PLAN
SCALE: 1/8" = 1'-0"

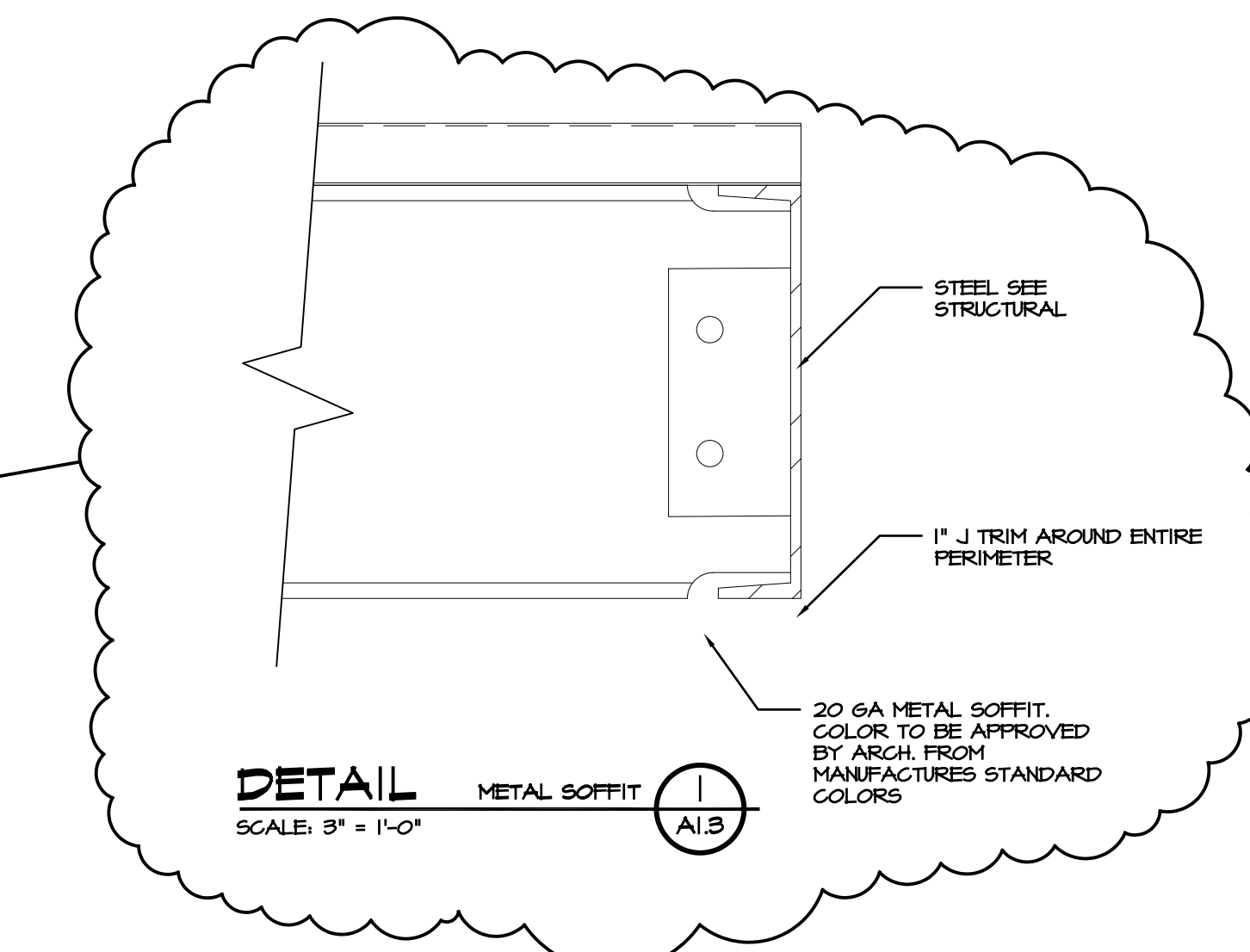

ADDENDUM #1
2-28-2019

DETAIL METAL SOFFIT
SCALE: 3" = 1'-0"

© JRV & ASSOCIATES, PLLC. DRAWINGS AND DESIGNS ARE PROTECTED BY COPYRIGHT AND THE ARCHITECT RETAINS TOTAL OWNERSHIP AND CONTROL. ANY UNAUTHORIZED USE OF DRAWINGS, DESIGNS OR IDEAS WITHOUT WRITTEN CONSENT OF THE ARCHITECT ARE PROHIBITED.

BRENT A. MCFARLAND AR-2561
2/15/2019
STATE OF IDAHO

JRV & ASSOCIATES
ARCHITECTS
1155 EAST CENTER STREET
POCATELLO, IDAHO 83204
PHONE (208) 839-2309 FAX (208) 369-2271
WWW.JRV.AZ

CONSULTANTS:
CONSTRUCTION MANAGING
 HEADWATERS CONSTRUCTION CO.
 900 Jet Stream Dr.
 Rexburg, Idaho 83440
 (866) 496-9868
 Fax (866) 496-0209
STRUCTURAL ENGINEERING
 FROST STRUCTURAL ENGINEERING
 1020 Lincoln Road
 Idaho Falls, Idaho 83401
 (208) 227-8404
 Fax (208) 227-8405
MECHANICAL ENGINEERING
 ENGINEERED SYSTEMS ASSOC.
 1355 East Center Street
 Pocatello, Idaho 83204
 (208) 233-0501
 Fax (801) 233-0529
ELECTRICAL ENGINEERING
 PAYNE ENGINEERING INC.
 1823 East Center St.
 Pocatello, Idaho 83201
 (208) 232-4439
 Fax (208) 232-1435

PROJECT: MADISON SCHOOL DISTRICT #321
MIDDLE SCHOOL HVAC REMODEL
REXBURG, IDAHO
DRAWING TITLE: MAIN LEVEL REF. CEILING PLAN

REVISION:	
#1 2-28-19	ADD #1
#2 3-4-19	ADD #2
DRAWN BY: JRN JOB NO: 746	
CHECKED BY: BAM DATE: FEB '19	
PLOT DATE: 3-04-19	

DRAWING NO. FILE: 746-A1.3-MRCP - A1.3
A1.3
OF 4